

SP601E DC5-24V Music Bluetooth LED Controller

Product Specification

Product name: SP601E WIFI LED controller

Input Voltage: DC5V-24V

Can Be Control: DC5V/12V/24V Addressable LED Strips

Support Pixels: 600pixels/channel max

Support IC: WS2811/WS2801/UCS1903/SM16716/LPD6803/LPD8806/LPD9813 etc

Remote distance: 15 meters

Control mode: APP (iOS or Android)

APP name: SceneX

Music Control: Built-in MIC

Effect: more than 36 dynamic effects

Memory: Automatic memory function

Speed Control: adjustable

App control

Both IOS version and Android OS version

Requires IOS version 10.0 or later;

Requires Android OS version 4.4 or later;

Search - "**SceneX**" in the App Store or Google Play or scan the QR code to download and install the App.

Supported chip

WS2811, WS2812, WS2813, WS2801, SK6812-RGB, SK6812-W/WA, LPD6803, LPD8806, UCS1903, UCS9812, APA102, APA104, TM1803, TM1804, TM1809, TM1812, TM1914, SM16703, etc.

Note:

- 1, Power supply/phone/controller/led strip not include.
- 2, This phone only supports 2.4G Wi-Fi network. Don't support 5.0G Wi-Fi network.
- 3, This app support Android 4.4 or above, IOS 10.0 or above.

Package includes:

1* SP601E Wi-Fi LED strip light controller (power and strip light not include)

1* 16Key RF remote

1 * User manual

Applications

1. Interior Decoration: Club, bar, corridor, room, hotel, led aquarium lighting, museum, Christmas, holiday, Retail LED lighting etc.

2. Exterior Decoration: Plaza, commercial buildings, parks, scenic spot, evening location, Sign illumination LEDs etc.

Safety

Supply voltage of this product is 5~24 Volts DC, do not exceed.

Shorting output wires may cause damage to dimmer.

Always observe proper polarity when connecting power and load.

For indoor use only – this product is not waterproof or weatherproof.

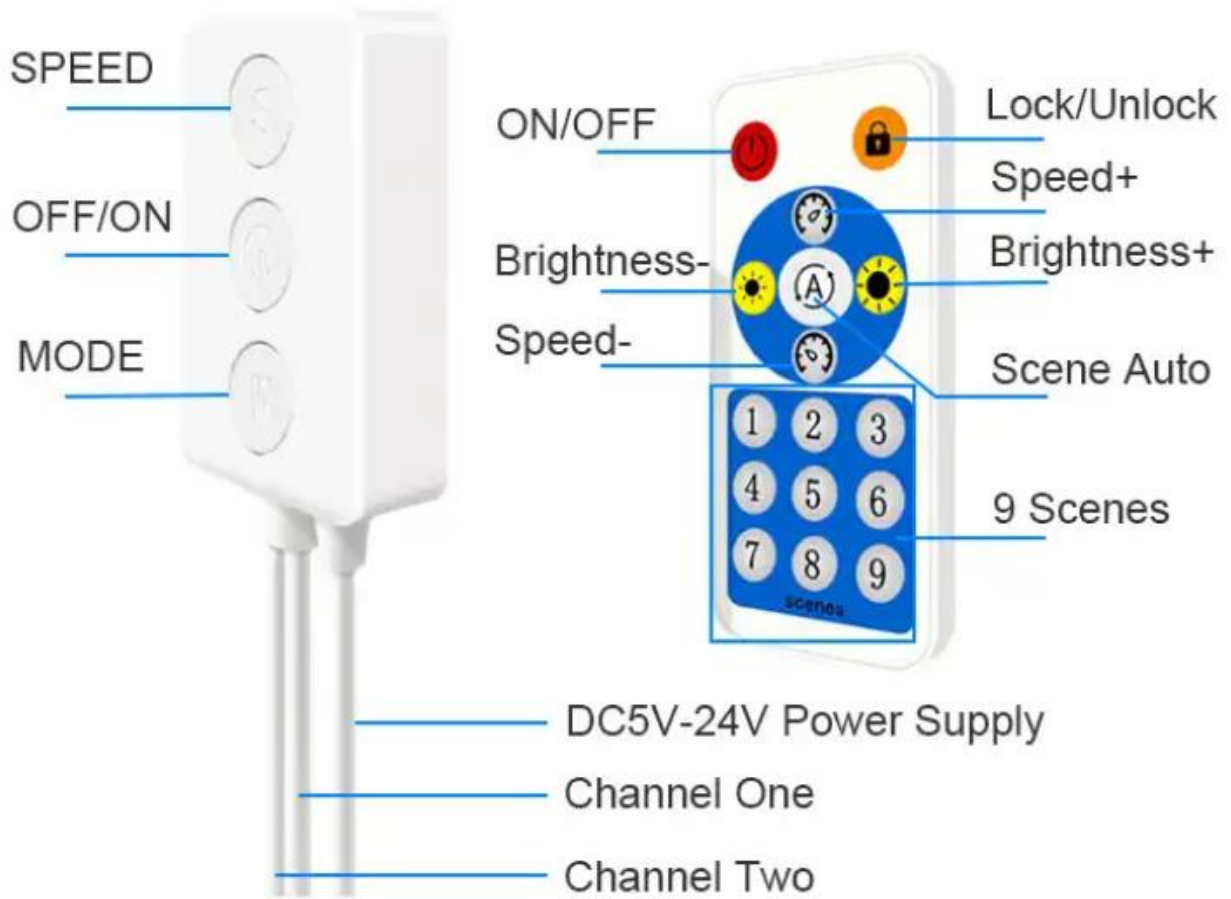

SP601E Dual Signal Output Pixel LED Controller

1. Features:

1. Supports both APP control and RF remote control;
2. Dual output of two different signals, suitable for a variety of applications and meet the different needs of customers;
3. Supports common single-wire LED driver ICs in the market ;
4. Build in Music and Non-Music effects, multi-parameters adjustable;
5. DC5-24V wide voltage input, with power supply anti-reverse connection function;
6. With the function of automatically saving setting parameters.



2. App Functions:





SP601E supports control by APP, supports IOS and Android system

Apple devices are required IOS 10.0 or later, Android devices are required Android 4.4 or later

You can scan the QR code to download and install the App:



App Operations:

- Open the app and click the  button in the top right corner of the home page to add a device, then click the device to access the control page.
- You can rename the controller by clicking the  button in the top right corner.
- SP601E can output two different signals, you can click on **channel 1** or **channel 2** to enter the corresponding page to control it individually, or you can click on **all channels** to control both channels in a unified way.
- After adjusting the effect of each channel, click  button in the upper right corner to save the current lighting effect settings to the scenes, SP601E supports a total of 9 scenes, users can call these 9 scenes through the scene page of the mobile app or use the RF remote control.
- Users can set up to five timing events by clicking on  in the upper right corner, please note that all set timing events will be deleted when the controller is powered down.
- In the effects page, there are a variety of music effects and non-music effects, users can set speed, brightness, color, direction and effect length for a specific effect.



3.RF Remote Functions:

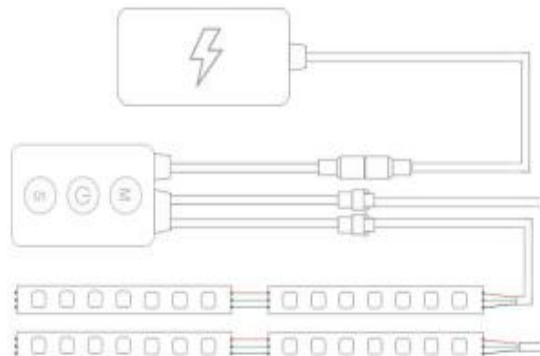

4. Wire Connection:



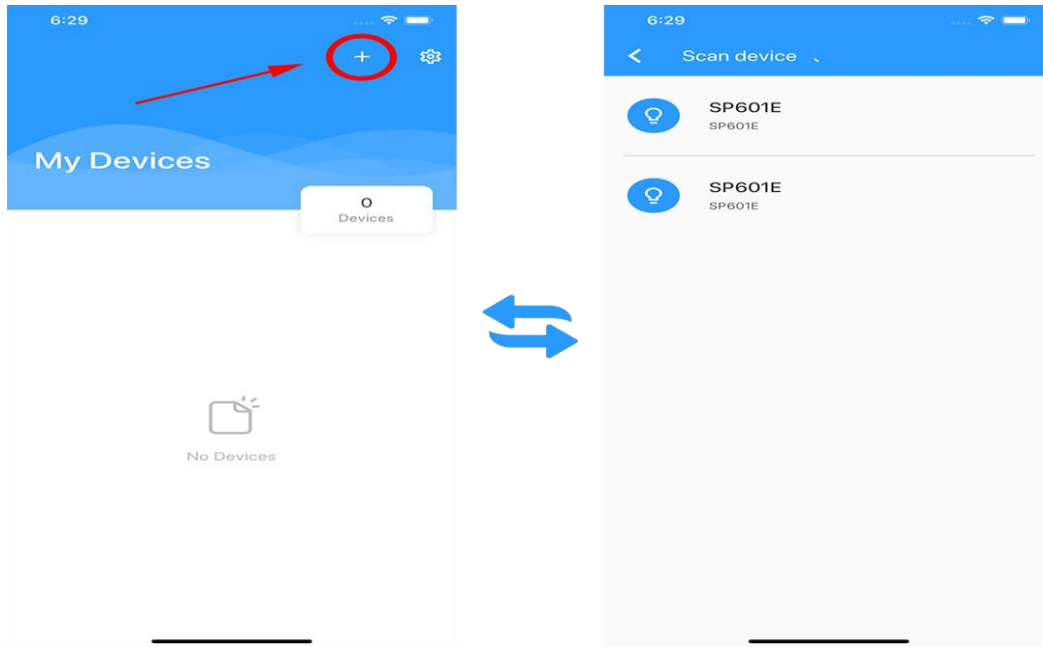

SP601E Bluetooth LED controller operating instructions

1. Connect to a new SP601E controller.
 - a. Open the app and click the  button in the top right corner of the home page to add a device, then click the device to access the control page.
 - b. You can rename the controller by clicking the  button in the top right corner.

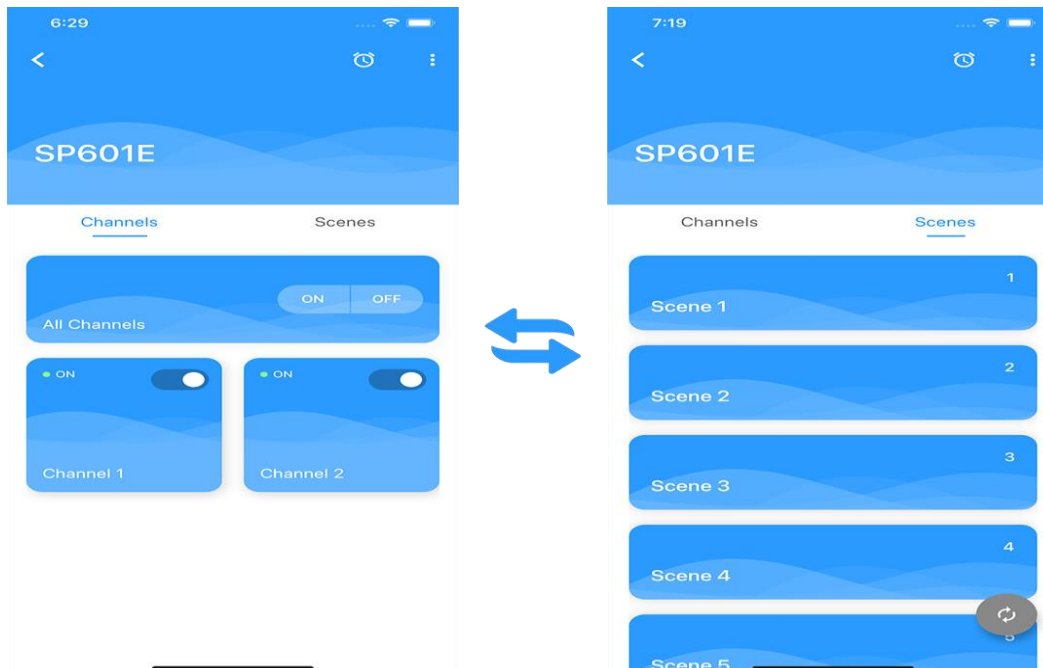

2. SP601E can output two different signals, you can click on channel 1 or channel 2 to enter the corresponding page to control it individually, or you can click on all channels to control both channels in a unified way.



3. You save the current lighting effect settings to these scenes.
 - a. After adjusting the effect of each channel, click  button in the upper right corner to save the current lighting effect settings to the scenes, SP601E supports a total of 9 scenes, users can call these 9 scenes through the scene page of the mobile app or use the RF remote control.

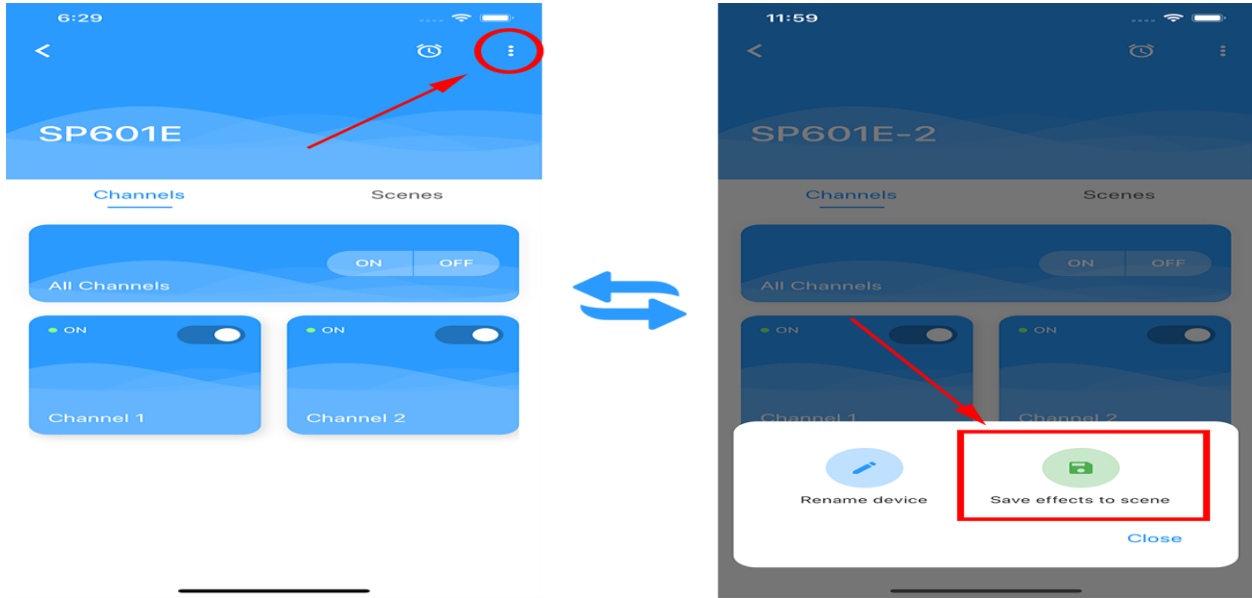

4. 36 built-in dynamic effects (1-24: general dynamic effects, 25-36: music effects) and solid color effect.
 - a. In the effects page, there are a variety of music effects and non-music effects, users can set speed, brightness, color, direction and effect length for a specific effect.

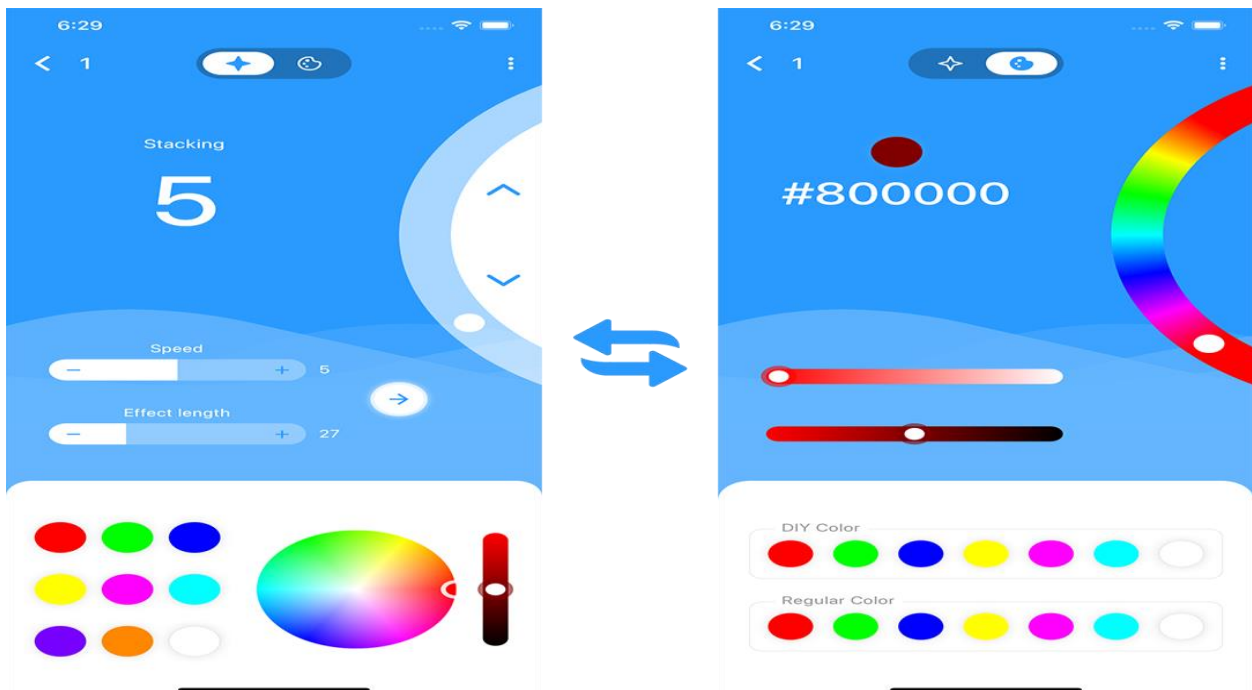

5. You can enter the RGB value of the color directly in solid color effect,

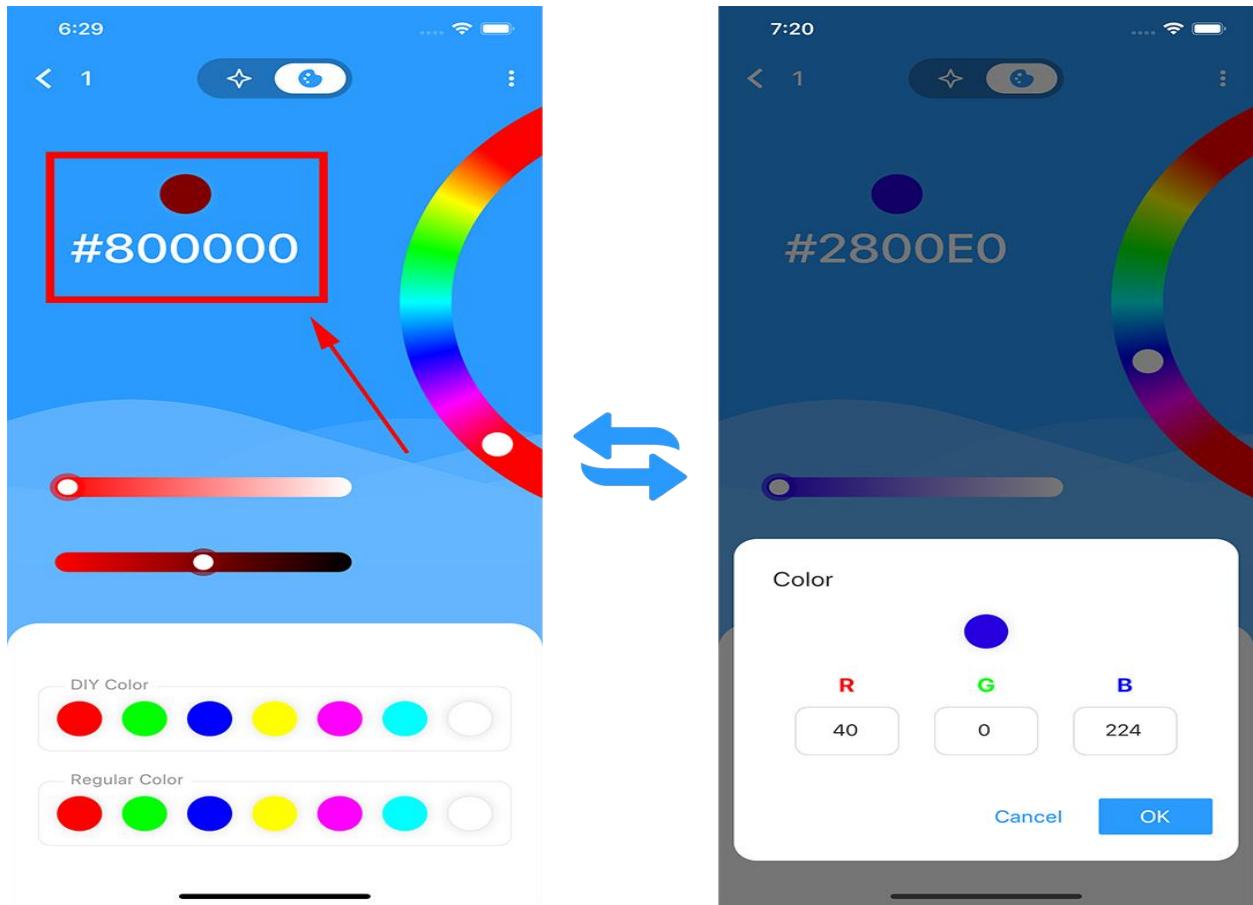

6. You can save your favorite colors.



7. SP601E can be set up to 5 timers by clicking on  in the upper right corner, please note that all set timing events will be deleted when the controller is powered down.

